

TAINER

Portable Backup Storage for Professionals

Upload and share memory cards through
CLOUDER



- User Guide : Firware 3.0 Lockable
- Version July 01, 2024

ClouZen Co., Ltd.
www.clouzen.net



Made in Korea

Copyright 2022©ClouZen Co.,Ltd. All rights reserved.

1 Setting and Disabling Internal SSD Security

1.1 Security Setting

The TAINER's security feature ensures that unauthorized access is prevented by requiring a user password. Initially, the TAINER is not locked, meaning no security password is set.



(1) Activating Security

When first used, the TAINER does not have any security password set. This means the device is unlocked and can be accessed without any authentication. To activate the security feature, select the security icon as shown in the figure.

(2) Setting the User Password

Enter your desired password in the provided fields using the wheel button on the right side of the TAINER.

After entering the password, move to the enter key on the bottom right of the LCD and select it to save the password.

(3) Confirm the password by entering it again.

(4) A message will confirm that the password has been set successfully.

(5) Preventing Unauthorized Access

Once the user password is set, the TAINER's security feature is enabled as shown in the figure. This security measure remains effective even if the SSD is removed from the device.

1 Setting and Disabling Internal SSD Security

1.2 Security Disable

There are two types of password operations: Unlock and Disable.

Operation	Details
Unlock	Temporarily disables security until the TAINER is powered off. After unlocking, data can be freely accessed until the TAINER is powered off. Once the TAINER is powered off and on again, it will be locked, requiring the password to access data.
Disable	Permanently disables the security system. After disabling, the TAINER will no longer require a password for access, even after power cycles.

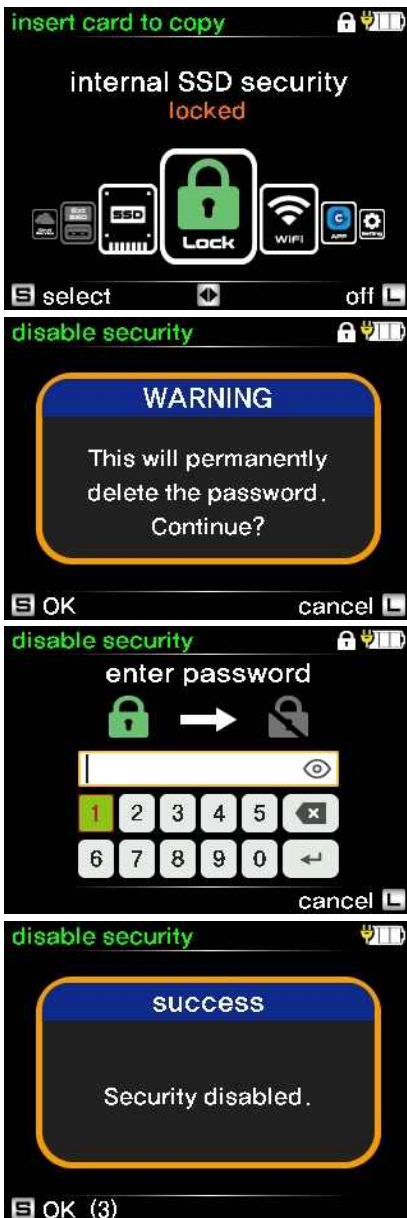

(1) To permanently disable security, select the security icon from the main menu as shown in the figure.

(2) Press the button briefly to confirm permanent password disable.

(3) Enter the password to disable it.

(4) Now the security is permanently disabled. A password will no longer be required to access the internal SSD.

1 Setting and Disabling Internal SSD Security

1.3 Security Unlock

Users can back up the memory card without a password since it is a writing activity. However, to access data from the internal SSD, the TAINER requires a password. Such activities include:

1. Accessing the internal SSD menu
2. Accessing the App menu
3. Connecting to a computer

To perform these activities, users need to enter a password to unlock the security. Once unlocked, it remains valid until the TAINER is powered off



(1) The security system status is indicated on the main menu as shown on the LCD.

(2) When activated (or locked), if a user connects a computer, the TAINER will prompt the user to enter the password as shown below.

(3) Enter the password to temporarily unlock the security until the device is powered off.

(4) Indicates unlocked successfully.